



LUCECO



Housebuilder Brochure

About Luceco plc

Luceco is a manufacturer and distributor of high quality and innovative LED lighting products, wiring accessories and portable power products for a global customer base. With over 70 years' experience, the Luceco PLC brands of Luceco LED Lighting, Kingfisher, BG Electrical, Masterplug and Ross are market leaders in key electrical categories, offering a "one stop shop" for trade and retail accessories.

BG Electrical – British General (BG) is the market leader within the UK across all sectors regarding wiring accessories, BG / Luceco products are installed in 1 in 5 new build properties each year. Furthermore, BG Electrical and Luceco lighting products are highly specified by major national housebuilders.

Luceco's growing presence in the Housebuild Market and the ever increasing number of housebuilders specifying Luceco and BG products are based on our reputation delivering reliability and functionality throughout the range of our innovative products. By offering cost effective solutions, market leading warranties, technical support, dedicated customer service and marketing backup, we aim to make it easy for our construction industry clients to specify and install sustainable lighting, circuit protection devices and stylish wiring accessories.

Our products are manufactured to the latest British Standards, the company's sites (both UK distribution and manufacturing) operate a BSI approved ISO 9001:2015 accredited quality management system. Our range of wiring accessories have been tested and approved by ASTA and proudly wear the diamond mark – a sign of quality.

Luceco believes that we have a responsibility to care for and protect the environment in which we operate. We are fully committed to improving environmental performance across all of our manufacturing and other business activities whilst providing sustainable and cost effective solutions to meet your business's objectives.

With **Offices in London, Jiaxing, Hamburg, Paris, Barcelona, Dubai, Mexico and Johannesburg** we offer sales and support to European, Mediterranean, Middle East, South America, USA, Africa & Asia Pacific regions. The UK distribution facility situated in Telford offers **10,000 square metres of manufacturing, assembly, distribution, warehousing and sales support.**

Our Brands



Wiring Accessories

British General (BG) is a wiring accessory brand, serving electrical trade professionals. Established in 1941, it is a well-respected brand and leader in the UK market. The business's growth is driven by product innovation, modern styling with ease of use for installers, and products manufactured to high quality and reliability standards.

- Wiring accessories, a range of switches and sockets in both plastic and decorative metal finishes, including USB charging sockets, Wi-Fi, Smart, exterior and IP weatherproof accessories
- Circuit Protection, Consumer Units, Protection Devices (MCB RCBO & RCD's) Control Devices (Time clocks and Contactors) and a selection of accessories to complement the range



Portable Power

Founded in 1988, Masterplug is the UK market leader in portable power, serving retailers and trade wholesalers. Offering solutions for home, garden, DIY, office and commercial applications, Masterplug is one of the world's most recognisable portable power brands, including the premium trademark Pro-XT range.

- Cable reels, extension leads, surge protection devices, timers and travel adaptors



LED Lighting

Luceco provides commercial and domestic lighting solutions, using energy saving and environmentally friendly LED lighting. Established in 2013, Luceco has rapidly become one of the leading brands for professional lighting in the UK with experienced project managers and a national distribution team supported by after sales and customer service functions.

- Efficient and intelligent solutions for a wide range of environments, incorporating market leading driver and wireless control technology
- Complementary Lighting Design service

LED Lighting

Kingfisher Lighting supplies exterior lighting LED luminaires, high-mast and street lighting systems and controls, as well as providing installation and maintenance services. Committed to environmentally accommodating external lighting with many products dark skies friendly with the use of energy efficient technologies, the dedicated team of lighting and mechanical engineers also offers complementary lighting design expertise.

- LED luminaires for distribution and warehousing applications, road & street lighting, car parks and urban landscapes
- High mast & flood lighting including transport, sports and MUGA environments

ROSS

TV Wall Mounts / AV Accessories

Ross is a leading manufacturer of premium TV wall mounts and AV accessories, sold worldwide through a growing network of trade and retail partners.

- TV mounts
- Reception, including indoor aerials
- Distribution – HDMI leads and TV interconnect accessories

Group Overview



Group global sales in excess of **£167m**



2500+ SKU
Product Portfolio



10,000m²
UK Warehousing and distribution facility located in Telford



75,000m²
WFOE Jiaxing manufacturing and best in class partnerships in Far East



Workforce **1626**



75
Years in Business



- Global integrated IT system
- Flexible distribution model



Continually evolving product ranges aligned to market trends

Everything under one roof.

Did you know...

Lucoco plc group of companies, BG Electrical, Lucoco LED Lighting, Masterplug Portable Power and Ross AV bring together an unrivalled product range making them the ideal partner for all of your projects.





LUCECO



About BG & Luceco

BG Electrical and Luceco are an integral part of the Luceco plc Group. Other brands include Masterplug and Ross, together they provide a 'One Stop Shop' for electrical accessories.

Quality & Reliability

We operate a BSI approved ISO 9001:2015 accredited quality management system and our product ranges have been tested and approved by many recognised accreditation authorities. To ensure production quality and performance reliability, products are tested in our on-site laboratory housing the latest test equipment. Products are subject to pre-shipment quality control inspections.

Product Innovation

BG Electrical is passionate about product innovation and we invest in R&D to ensure our products meet the needs of an ever changing market. Our USB socket range is testament to this commitment and our new product development programme. Our R&D facility boasts a team of research & development, product packaging and tooling engineers, ensuring time to market development is minimised.

- Products combine modern styling with time saving, ease of installation features such as in-line colour coded terminals and backed out captive screws
- Continuous product development to meet market & customer needs
- Style and Functionality are key factors and fundamental to our success

Customer Support

The business's professional sales and technical teams support our customers' requirements. Together with EDI trading technology and advanced supply chain management, we strive to ensure high levels of service.

- Central Distribution Warehouse and Assembly Facility based in Telford
- Site and next day delivery service
- UK Area Sales Teams, Customer Services and Marketing Support
- Technical Support Team and online self-help advice fundamental to our success

Guarantees

BG Electrical is confident in the quality of our workmanship and materials. We are therefore proud to offer a substantial guarantee on our product ranges.



Nexus round edge white moulded products are guaranteed against faulty materials and workmanship for a period of 30 years from date of delivery.



BG Electrical moulded square edge, euro module, decorative, metal clad, ceiling and lighting accessories, cable management, junction boxes and contractor range are all guaranteed against faulty materials and workmanship for a period of 25 years from date of delivery.



BG Circuit Protection, USB and WiFi Sockets products are guaranteed against faulty materials and workmanship for a period of 10 years from date of delivery.

Ethical Policy

The Luceco Group has an overriding obligation to the welfare of workers within its own manufacturing facility and supply chain. Luceco uses the Ethical Trading Initiative (ETI) Base Code as its standard for its own manufacturing operation and all primary suppliers across all our businesses.



Sustainability

Our manufacturing facilities has ISO 14001:2015 approval regulating our environmental management systems. We continually aim to reduce our environmental impact from both products and activities.

We are always looking for new methods and materials to provide environmentally friendly solutions. To support construction waste requirements, BG is able to supply products for agreed projects with minimal packaging waste. In addition, we will ensure that all products sold are disposed of in a responsible manner and we are registered with a notified service provider for compliance with the Directive 2002/96/EC - WEEE (Waste Electrical and Electronic Equipment).



Why LED?



Environmentally Friendly

Fluorescent lighting contains mercury. LEDs do not. This makes LEDs safer both to use and dispose of. The mercury contained in just one fluorescent lamp is enough to contaminate 30,000 litres of water beyond safe drinking level limits. Fluorescent lamps are therefore classified as 'hazardous waste'.



Cost Effective

The true cost of fluorescent lighting is not only in its energy consumption. There is also maintenance over its lifetime, replacement labour and lamp outlay, and disposal costs. With LED, these costs don't exist. LED is a Fit & Forget solution.



Safe Lighting

LEDs emit minimal Ultra Violet light (UV). UV light attracts insects and can be harmful to skin, clothing and artwork. Heat emissions are greatly reduced with LED, which means they are cool to touch and perfect for heat sensitive applications.



Durability

LEDs do not contain a filament that can be damaged by shock and vibration - making LED one of the most stable light sources available.



Instant Light & No Flicker

LEDs produce 100% light instantly, with none of the warm up time required by fluorescents. Plus they are free of visible flicker - ideal to help prevent discomfort associated with traditional lighting.



Long Life

The life of LED is between 4 and 40 times greater than traditional products. What's more, they produce consistent light output over their entire life.

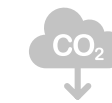

Reduced Carbon Emissions

LEDs converts up to 80% of energy into light. This both reduces electricity costs and dramatically reduces carbon emissions.



Home Automation Wiring Accessories

Home Automation sockets provide convenient solutions for modern lifestyle needs.

The BG range includes smart sockets and WiFi extender sockets with USB ports for the best user experience with Wi-Fi connected devices.

Smart Sockets

Take control of your connected devices from anywhere with BG Smart power sockets and adaptors. This affordable retro-fit smart home solution is compatible with Amazon Alexa, Google Assistant, Siri Shortcuts and IFTTT for full smart home integration.

- Simple installation and setup
- Control with mobile, voice or touch
- Connect via Wi-Fi - no Home Hub required
- Minimum mounting box depth 25mm
- Terminal capacity 3 x 2.5mm², 3 x 4.0mm² & 2 x 6.0mm²
- Manufactured to BS1363-2:2016

Available in Gloss White:



Power controlled by:



USB Sockets

Free sockets and charge devices without having to sacrifice a power socket. Designed with angled, colour coded terminals and backed out screws for ease of installation.

- Smart USB - Standby mode when device is fully charged
- Auto Detect's the USB device and adjusts charging pattern to suite
- Twin earth fitted as standard for high integrity circuits Ref. BS 7671:2008
- Minimum mounting box depth 25mm
- Terminal capacity 3 x 2.5mm², 3 x 4.0mm² & 2 x 6.0mm²
- Manufactured to BS1363-2:2016
- 10 Year guarantee



Available in 3 stocked finishes:



WiFi Extender Sockets

This 13A double power socket with integrated Wi-Fi extender will eliminate dead spots and expand Wi-Fi coverage. The integrated USB port allows you to plug in electrical devices and charge mobile devices simultaneously without having to sacrifice a power socket.

- Works with all wireless broadband routers
- Easy to install and setup with one-touch WPS
- N300 Wi-Fi Technology - Up to 300Mbps data transfer speed
- Twin earth fitted as standard for high integrity circuits Ref. BS 7671:2008
- Minimum mounting box depth 25mm
- Terminal capacity 3 x 2.5mm², 3 x 4.0mm² or 2 x 6mm²
- Manufactured to BS1363-2:2016



Available in 3 stocked finishes:



Nexus Metal Wiring Accessories

Premium metal accessories, in a range of superior quality finishes that will complement any interior décor.

Featuring a moisture control gasket to protect metal edges and prevent tarnishing from new plaster, with softly rounded edges, colour match fixing screws and no visible plastic around switches for a premium finish.



BG Electrical products are guaranteed against faulty materials and workmanship for a period of 25 years from date of delivery.

All products available in 3 stocked finishes:



Switches

A comprehensive range of switches for all applications, with captive backed out screws for straightforward installation.



Sockets

Stylish and practical, Nexus Metal sockets have in-line colour coded terminals and backed out captive screws for ease of installation.



Co-ax & Satellite

A comprehensive range including screened and isolated sockets, designed to ensure excellent reception in all types of housing.



Telephone & Data

Available with screw and IDC terminals, colour coded shutters and ID windows for data outlets.



Dimmers

Dimmer switches allow you to adjust your lighting to suit the situation and mood. Suitable for use with compact fluorescent lamps (CFL) and LED dimming.



Shaver Sockets

Nexus Metal dual voltage shaver sockets are suitable for use with 240V and 115V shavers and electric toothbrushes.



Media Plate

1 x 2 gang DP 13A switched sockets & 4 Euro Modules or 2 x 2 gang DP 13A switched sockets & 8 Euro Modules.



Blank Plates

Ideal for covering unused electrical connections with Nexus Metal classic styling.



Flatplate Wiring Accessories

Slimline screwed and screwless accessories available in a range of decorative finishes.

Featuring a moisture control gasket to protect metal edges from moisture, with a flush to wall fit and no visible plastic around switches for a premium finish.



BG Electrical products are guaranteed against faulty materials and workmanship for a period of 25 years from date of delivery.

All products available in 3 stocked finishes:



Switches

Flatplate switches sit flush against the wall for a modern and stylish finish, with no visible plastic around the switches for a clean and seamless appearance.



Sockets

Stylish and practical, Flatplate sockets feature in-line colour coded terminals and backed out captive screws for ease of installation.



Co-ax & Satellite

A comprehensive range including screened and isolated sockets, designed to ensure excellent reception in all types of housing.



Telephone & Data

Available with screw and IDC terminals, colour coded shutters and ID windows for data outlets.

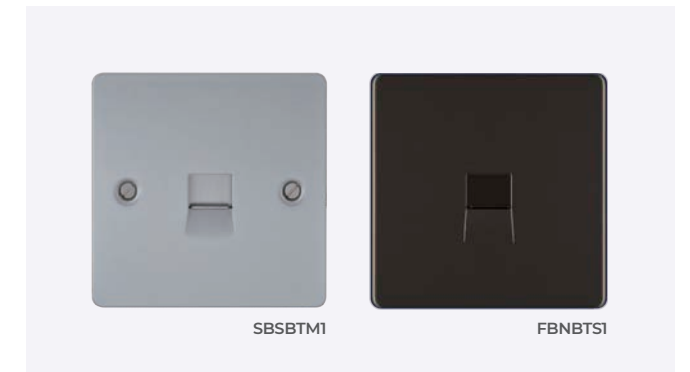

Dimmers

Dimmer switches allow you to adjust your lighting to suit the situation and mood. Suitable for use with compact fluorescent lamps (CFL) and LED dimming.



Shaver Sockets

Flatplate dual voltage shaver sockets are suitable for use with 240V and 115V shavers and electric toothbrushes.



Blank Plates

Ideal for covering unused electrical connections with a discreet flat finish that matches other accessories within the range.





Nexus Grid Wiring Accessories

Nexus Grid is ideal for domestic applications, particularly in kitchens where there are various combinations of lighting and power required.

Nexus Grid matches other Nexus finishes to provide continuity of wiring accessories throughout the house.



BG Electrical products are guaranteed against faulty materials and workmanship for a period of 25 years from date of delivery.

Nexus Grid

The Grid modular range from British General allows you to build your own configuration with a variety of combinations and finishes.

- Front plates, grid frames, boxes, rockers, indicators, dimmers, fused & flex outlets, 20 Amp modules
- Easy to install with cantilever module to frame installation
- No visible plastic around switches
- Interchangeable rockers provide flexibility
- Available in 3 profiles – Nexus Metal, Screwless Flatplate and Metal Clad

Available in 5 stocked finishes:



Quick & Easy Installation

- Step 1**
Screw grid frame to mounting box
- Step 2**
Wire modules
- Step 3**
Slot the module on to the frame and click into place
- Step 4**
Fit the plate

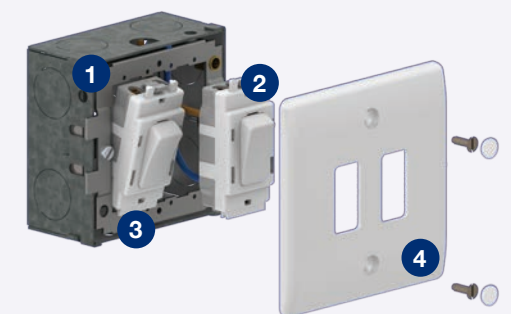



White Moulded Wiring Accessories

Available with round edge profile, for a premium feel offering exceptional value.

Produced in white moulded urea material with inherent anti-microbial properties, promoting a healthy environment by facilitating up to 99% reduction in bacterial development on touch point surfaces.



BG Electrical products are guaranteed against faulty materials and workmanship for a period of 30 years from date of delivery.

All products available in 1 stocked finish:



Switches

A comprehensive range of switches for all applications, with captive backed out screws for straight forward installation and screw covers for a sleek appearance.



Sockets

Switched and unswitched solutions with a high resistance to fading, discolouration and scratches. Designed with angled in-line terminals and captive screws for ease of installation.

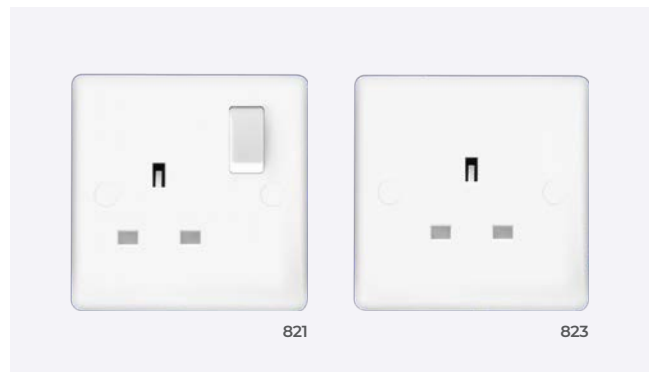

Co-ax & Satellite

A comprehensive range including screened and isolated sockets, designed to ensure excellent reception in all types of housing.



Telephone & Data

Available with screw and IDC terminals, these outlets come with shutters and ID windows for data outlets.



Dimmers

Dimmer switches allow you to adjust your lighting to suit the situation and mood. Suitable for use with compact fluorescent lamps (CFL) and LED dimming.



Shaver Sockets

Dual voltage shaver sockets suitable for use with 240V and 115V shavers and electric toothbrushes, with screw cover caps that protect screw heads from moisture in damp environments.



Media Plate

This combination plate combines 4 x 13A switched sockets with an 8 module aperture where a variety of different power solutions can be fitted.

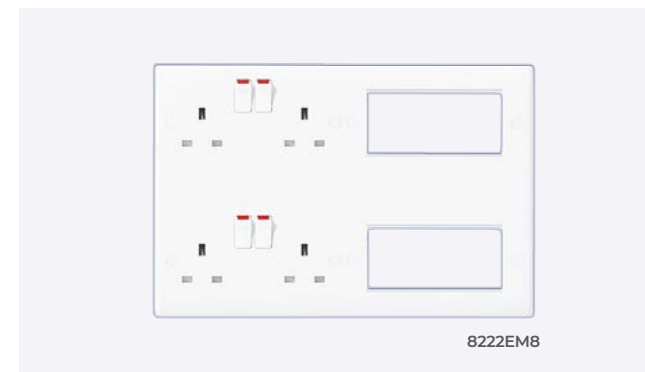

Blank Plates

Ideal for covering unused electrical connections.





NEW
from BG



Power Socket **DOOR CHIME**

Double Switched 13 Amp

Innovative 13A double power socket with a built-in door chime and wireless push button. No wiring to the door frame required and no bulky wireless adaptor needed, keeping sockets free.

- **Easy to fit** - the socket fits a standard 25mm back box, features angled in-line colour coded terminals with captive screws and twin earth for high integrity circuits.
- 100m (open air) wireless range and ability to pair multiple sockets and push buttons, make this ideal for larger homes.
- 1 in a million random code ensures no interference with neighbouring door chimes.
- Volume can be adjusted from mute up to 80dB to suit the location of the socket.
- LED indicator provides visual indication of door chime activation, ideal for mute mode, noisy households and the hard of hearing.
- Inherent anti-microbial properties prevent 99% of bacterial growth on touch point surfaces, for residential and commercial environments.



822BELL



**CASE
STUDY**

BG Electrical at home at Graven Hill

Luceco and BG Electrical, part of the Luceco group, has supplied wiring accessories, circuit protection and energy saving LED lighting for an exciting new development at Graven Hill near Bicester. Over 100 stunning open-plan apartments, offering panoramic views of the Oxfordshire countryside, are being constructed as part of a new village development. Studio, one-bed and two-bed luxury apartments are being built alongside retail spaces, pubs as well as a pre-school nursery and primary school.

BG Electrical's white moulded 800 series of wiring accessories were chosen for the contemporary apartments. The 800 series features a smooth rounded edge finish with a modern slim profile.

Sustainability is a vital part of the project and renewable energy will be harnessed where possible as well as energy saving cost effective LED lighting from Luceco. Luminaires included the Atlas, Mosi and Sierra bulkhead style fittings, Carbon downlighters, IP65 Climate linear fittings, mirror lights and emergency lighting throughout the development.

Fortress Circuit Protection from BG Electrical has also been chosen. Fortress is a range of consumer units, enclosures, devices, surge protection and accessories for domestic installations designed to meet the requirements of the 18th edition wiring regulation. Dual RCD consumer units were supplied and are available as populated or unpopulated

up to 22 modules with 100A Main Switch and 2 x 63A, 1 X 80A 1 x 63A and 2 x 100A and RCD combinations with SPD option. Fortress metal consumer units feature a modern stylish design in gloss white finish, complementing the Nexus wiring accessories profile. Tested to all relevant standards, Fortress offers fast and simple installation, flexibility for maximum circuit combinations including easy upgrades and the peace of mind with a 10 Year Guarantee on faulty materials and workmanship.

Graven Hill apartments are designed to maximise space and comfort whilst offering spectacular views of the Oxfordshire countryside. In terms of location, Graven Hill is ideally placed at the heart of the 'Golden Triangle' created by Cambridge, Oxford and London. Graven Hill not only represents one of the most creative and unique developments in the UK, it also forges a path as one of the first large-scale greenbelt urban communities in the country.





Weatherproof Wiring Accessories

IP rated accessories designed to protect against water and dust ingress in the most arduous conditions, and ideal for managing outdoor and garden appliances. The 3 ranges include Decorative IP66, Nexus Storm IP66 and weatherproof IP55.



Decorative IP66

Premium weatherproof accessories with a stylish stainless steel finish, supplied with a multiple knock out mounting box and double pole switches for additional safety.

- Stylish stainless face plate on a polycarbonate housing and black mounting box
- Hex style cover fixing screws – key supplied
- Blue LED indicator that can be wired to illuminate when switch is off or on, also included with switched sockets
- IP66 Rated with plug in use, cover sealed



WPL12



WPL42



WPL21



WPL22

Nexus Storm IP66

This wide range of accessories for outdoor use includes sockets, switches, junction boxes, FCU's and Wi-Fi extender sockets.

- Ergonomic design with see through cover
- Robust high impact UV stable housing
- Stay open socket cover
- Multiple gland entry positions & quick to wire



WPI2S



WPI4



WP21



WP22

Features & Finishes

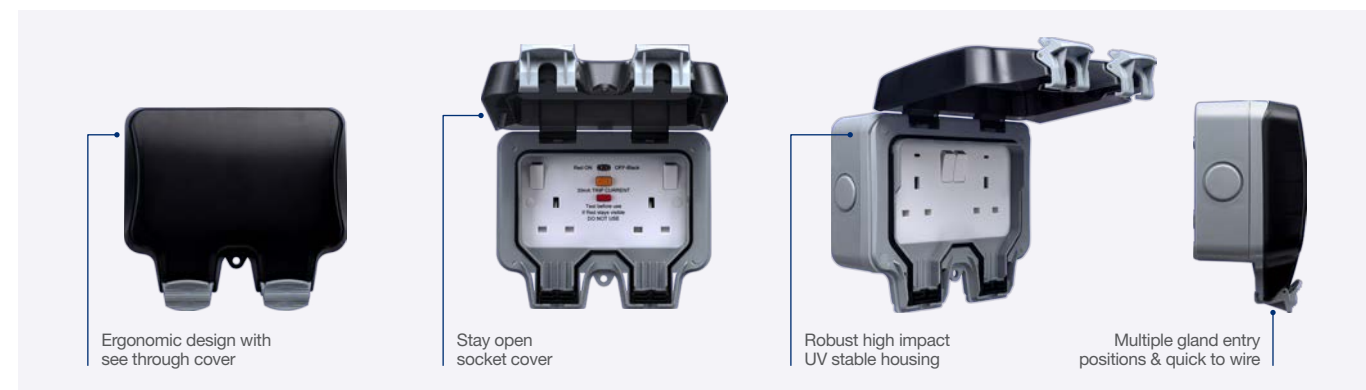

Available in 2 variations:



Decorative



Nexus Storm

WiFi Extender

This socket is housed in a weatherproof case and allows you to extend your Wi-Fi reach to the garden so you can use all your devices outdoors as well as indoors.

- Works with all wireless broadband routers
- Easy to install and setup with one-touch WPS (Wi-Fi Protected Setup)
- Perfect for streaming music and videos or playing online games
- N300 Wi-Fi Technology, Up to 300Mbps data transfer speed
- IP66 Rated with plug in use, cover sealed
- 13A socket manufactured to BS1363-2
- Wireless 2.4GHz single band



WP22WR



BG Electrical products are guaranteed against faulty materials and workmanship for a period of 25 years from date of delivery.



Circuit Protection

Fortress Circuit Protection is a range of Consumer Units, Enclosures, Devices, Surge Protection and Accessories for domestic installations designed to meet the requirements of the 18th Edition Wiring Regulation.

18TH EDITION

Features & Finishes

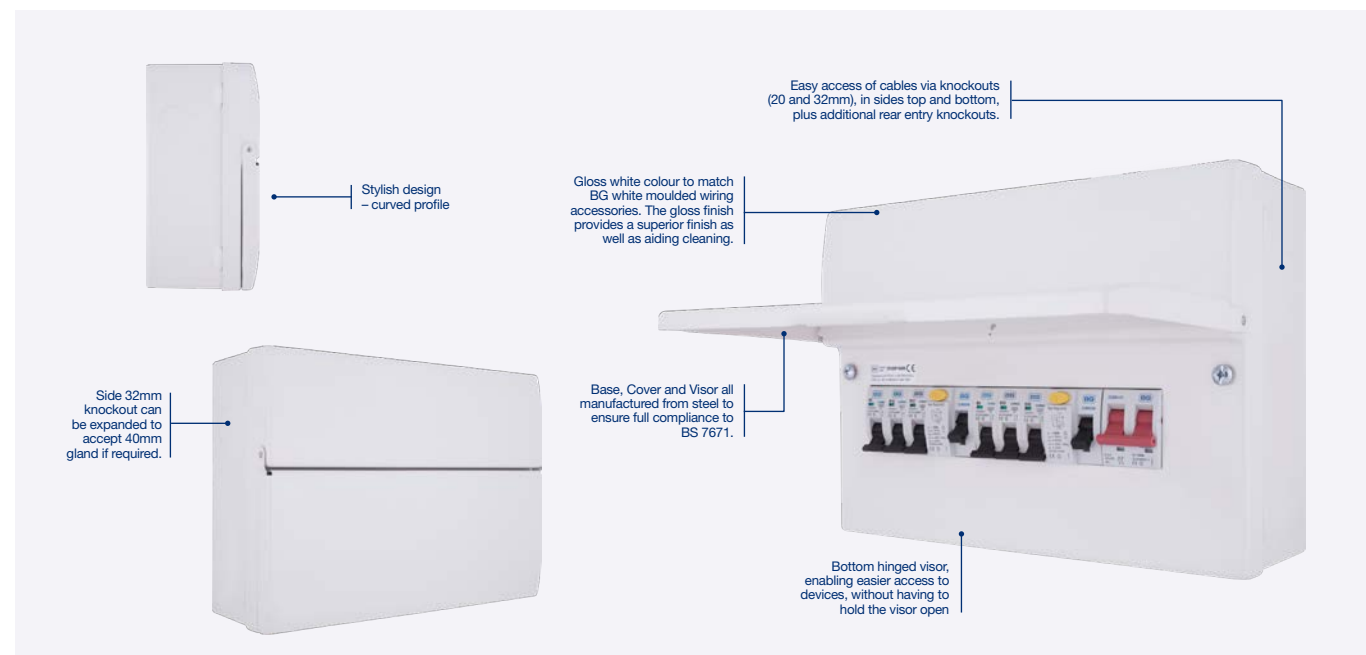

Consumer Units

- Modern stylish design with a profile that matches BG wiring accessories
- Flexibility for maximum circuit combinations and easy upgrades
- Fast and simple installation
- Consumer unit and devices tested to all relevant standards
- 10 Year Guarantee



Recessed Consumer Units

- Available in Main Switch, RCD, Dual RCD, in both Populated and Unpopulated versions
- Specifically designed to be fully recessed into a wall or cavity up to a depth of 68mm
- Covers have barrel lock installation capability and comes with cover lock blank
- Fast and simple installation



IP Rated Enclosures

- 5 Module enclosures accept SP RCBOs
- IP65 enclosures c/w Ø20mm knockouts on all sides drillable to Ø32mm
- Enclosure kits supplied complete with devices, DIN rail, neutral cable, neutral & earth terminals, cover blanks and busbar



Control Devices & Accessories

- Wide range of additional control devices
- Contactors are Ideal for controlling large lighting loads, heating or ventilation systems
- The bell transformer is for use with mains powered door chimes which do not have integrated transformers.



MCB's, RCBOs & RCDs

- Positive contact status indication
- Available in type B or C
- Device capable of being locked in 'ON' or 'OFF' position using a device lock



SPDs

- No resetting of SPD required, the excess voltage is quickly taken to earth, before the rest of the circuits are damaged
- Meets the requirements of the IEC 61634-1 and EN 61643-11 standards
- An SPD enclosure can be fitted next to any existing or new Consumer Unit of any brand where surge protection is required
- SPDs have indicators to advise end of life of the device



AFDD – Arc Fault Detection Device

An AFDD utilises electronic technology to analyse the signature (waveform) of an arc to differentiate between normal arcing and arcing faults between L-L, L-N & L-E. Upon detection of an arcing fault, the AFDD disconnects the final circuit from the supply.

A new Regulation 421.1.7 has been introduced recommending the installation of arc fault detection devices to guard against the risk of fire in AC final circuits of a fixed installation, due to the effects of arc fault currents. Areas recommended include:

- Premises with sleeping accommodation
- Locations at risk of fire due to materials stored e.g. barns, warehouses and workshops
- Fire propagating structures
- Locations with irreplaceable goods and heritage sites

Smoke Alarms

BG supply both mains powered and battery powered alarms, including Ionisation and Optical variants along with Carbon Monoxide and Heat Detectors to complete the range.



Door Chimes

BG doorbells can be supplied as a mains powered door chime with built in transformer or as a kit supplied complete with white plastic, brushed steel, polished chrome or brass bell push.



BG Electrical products are guaranteed against faulty materials and workmanship for a period of 25 years from date of delivery.



Ceiling & Lighting Accessories

British General ceiling and lighting accessories combine modern styling with ease of use for installers. The extensive range includes ceiling roses, pendant sets, batten holders and fluorescent starters.

Lamp Holders & Pendants

Ceiling roses, pendant sets and batten holders have several common features that aid the speed and ease of installation.

- Incorporates L, N and Loop-in terminals with 8 individual cable entries and captive screws
- Spin on covers with smooth cable entry for maximum protection of pendant conductor insulation
- Wiring aperture with extra knockouts for ease of wiring
- Alternative fixing holes to allow for off centre mounting
- Large capacity earth terminal with locking terminal screw





Electric Vehicle Charging Accessories

Domestic Mode 2 electric vehicle charging station. 3-pin UK socket with 16A RCBO protection. Can be used as an outdoor power socket.



Mode 2 EV Charger

- For use with Mode 2 EV charging cables (UK 3 pin to Type 1 or Type 2)
- 13A unswitched socket with 16A DP Type A RCBO, for added localised safety protection during prolonged charging
- Water and dust protection to IP66, with covers for each compartment
- Gives 8 miles per charging hour
- Compatible with all Mode 2 EV charging cables
- Meets housebuilder EV specification
- Suitable for use a regular outdoor power socket



Ask us for details on Mode 3 electric vehicle charging.

Interior LED Lighting

A complete range of downlights available, up to 90 minutes fire rated with options available on finish, colour temperature and adjustability.



Element LED Fire Rated Downlight

- Fire rated LED downlight
- First fix/second fix removable connector and remote driver
- Shallow height for use in small ceiling voids
- Choice of interchangeable bezel types and finishes
- Luceco emergency pack compatible



Interchangeable bezels available:



Adjustable



Fixed

Regressed

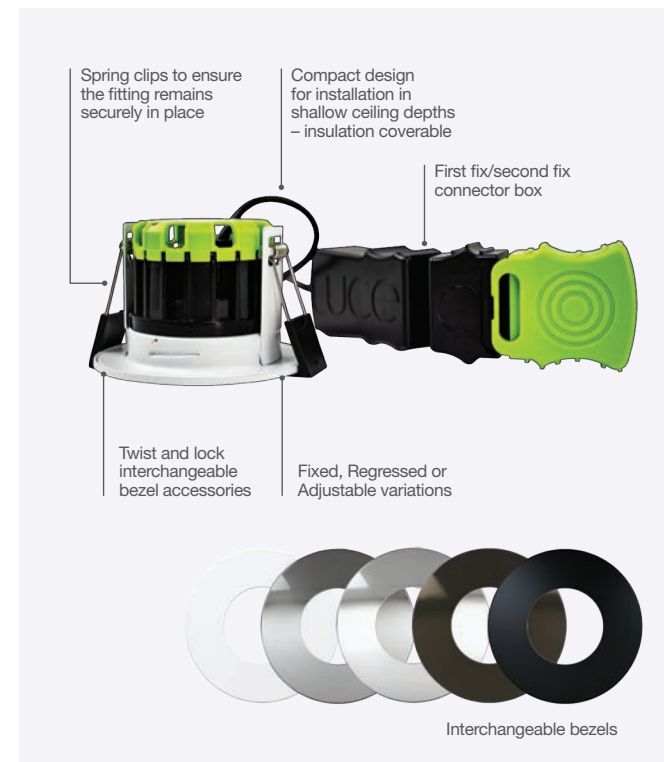

LUCECO

I-JOIST CERTIFIED

In accordance with BS 476-21 the following Luceco ranges have been tested and certified for 30 minute I-Joist ceiling systems

- ✓ FType
- ✓ F-ECO
- ✓ Element
- ✓ Fire Rated GU10

Ftype LED Fire Rated Downlight

Available in both 6W and 8W and using the latest Samsung LED chips to deliver up to 100 Lumens per Watt, its integrated dimmable driver, and Speedfit™ loop in/loop out piano key terminals for fast and simple installation on both stranded and solid wire cable, make FType one of the most efficient and optimum Fire Rated Downlight ranges on the market.

- Smart Colour Change and Dim2Warm options
- Up to 100lm/W in fixed, adjustable and regressed
- Toolless connectors and installation
- Range of interchangeable bezel accessories
- 5 year warranty



Interchangeable bezels available:



F-ECO LED Fire Rated Downlight

Downlights are increasingly used in residential and commercial spaces for both general and accent lighting. The appearance of a clean ceiling line enhances the modern environment.

- Super shallow recess depth
- Detachable connector box
- Available in fixed and adjustable
- Range of finishes available
- 3 year warranty



Available in 3 stocked finishes:



ECO Circular Slimline Downlight

A complete range of downlights available, up to 90 minute fire rated with options available on finish, colour temperature and adjustability.

- White aluminium frame with polycarbonate TPb diffuser
- Slimline design ideal for low ceiling voids
- Suitable for plasterboard or suspended ceiling systems
- Plug and play driver
- Super shallow 20mm luminaire recess depth
- Luceco emergency pack compatible



Decorative Indoor Bulkhead

- Decorative interior residential bulkhead, ideal for bathroom areas
- Supplied with white and polished chrome interchangeable bezels
- Polycarbonate housing



Available in 2 stocked finishes:



Under Cabinet Slimline Panel

- Super slim profile with high light output - perfect for most discrete lighting applications
- Directly interconnectable end-to-end or with accessory leads for both straight or angled installations – interconnectable up to x3
- Motion sensor switch provides both on/off and dimming control
- Ideal applications include: above, inside or under kitchen cabinets, shelving, book and display cases, caravans and mobile homes



Exterior LED Lighting

Exterior LED illumination extends the living space of your house, enhancing patio and decked areas as well as gardens and landscapes. LED lighting is the perfect solution to aid accessibility, security and safety as well as being energy efficient and a cost effective return on your investment.



Mosi Bulkhead

Bulkheads are an essential part of many lighting installations, typically used either ceiling or wall-mounted, internally or externally.

- Bulkhead for internal or external applications
- Polycarbonate base and diffuser for increased durability
- Surface mounting luminaire with 4 side and 1 rear conduit entry points
- Microwave control and emergency versions available



Available in 2 stocked finishes:

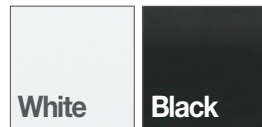

Decorative Outdoor Bulkhead

Our wide range of bulkheads are available in multiple decorative finishes with suitable ingress protection. Additionally, some ranges offer microwave sensors for presence detection.

- Easy quick installation
- High impact and durable housing
- Adjustable PIR, lux and time settings
- Supplied with interchangeable black and white bezels



Available in 2 stocked finishes:

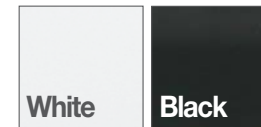

Floodlights

Residential floodlights come in different sizes and are available with PIR sensor where required for presence detection and additional security. Commercial floodlights are larger, more powerful and designed for extended operating hours.

- Market leading LED floodlight; ideal for multi-purpose residential use
- Die-cast aluminium housing for maximum durability
- Easy installation with a fit and tilt bracket
- Various colour temperatures available to suit all applications
- Supplied with 1m of cable; ideal where through-wall wiring is necessary



Decorative Wall Lights

The Exterior Decorative range combines performance with aesthetics to create functional and beautiful outdoor spaces. They are designed to match in colour temperature, finish and construction.

- Decorative LED wall light
- Die-cast aluminium with a slate grey finish
- Suitable for exterior or interior living applications



Decorative Coach Lantern

Light up your garden with our amazing exterior decorative lighting collection. Premium quality, dynamic and durable.

- Decorative appearance E27 coach lantern
- Die-cast aluminium housing with 6 glass panels and extended outreach
- Adjustable PIR sensor with time and lux level settings



Solar Lighting

Our new Solar LED range gives you the flexibility to light up any space.

- Ideal for spaces without mains power, fast and simple installation, no wiring required
- Perfect for outdoor entrance areas, balconies, walkways, decorative garden lighting, and sheds/outhouses
- PIR / Photocell with security and presence detection modes of operation



Stainless Steel Wall Lights

Stainless steel constructed decorative wall light with fully integrated LED

- Fixed and adjustable head options
- Suitable for use as ambient or decorative lighting
- PIR option available for Up/Down Fixed



Bollards

Robust bollard with a classic domed top.

- Robust aluminium construction finished in grey RAL7016
- Indirect light distribution and carefully engineered reflector with low glare 1350lm at 20W this bollard also has the capability for emergency and photocell options
- Easily installed using the flange plate or bolt on root option

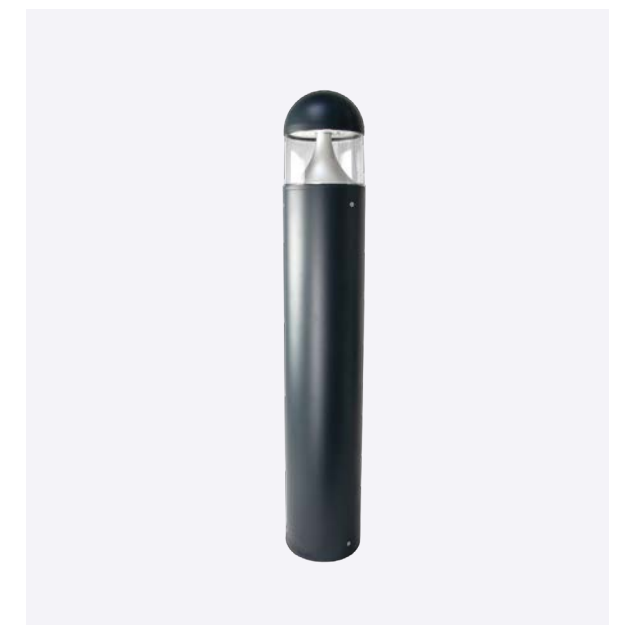



LUCECO

UK:**HEAD OFFICE:**

Email: info@luceco.com

Luceco plc, Caparo House
103 Baker Street, London
England, W1U 6LN

DISTRIBUTION CENTRE:

Tel: +44 (0) 1952 238 100
Email: uk_sales@luceco.com

Luceco plc
Luceco Distribution Centre
Stafford Park 1, Telford
Shropshire, England, TF3 3BD

GERMANY:

Tel: +49 40 89066 878 - 0
Email: eu_sales@luceco.com

Nexus Industries GmbH
Holstenplatz 20b
22765 Hamburg, Germany

FRANCE:

Tel: +33 (0)1 61 10 10 35
Email: fr_sales@luceco.com

Luceco SAS France & Belux
3 Rue de Courtalin
Magny Le Hongre 77700
Paris, France

ITALY:

Tel: +39 0434 1696795
Email: it_sales@luceco.com

Luceco Southern Europe,
S.L. Via Amman 10
33170 Pordenone, Italy

SPAIN:

Tel: +34 93 829 55 75
Email: es_sales@luceco.com

Nexus Industries LTD
C/ Bobinadora 1-5
08302 Mataró
Barcelona (SPAIN)

MIDDLE EAST:

Tel: +971 4 609 1867
Email: mea_sales@luceco.com

Luceco Middle East FZCO
Bldg. 5EB, Office 342
PO Box 371128, DAFZA
Dubai, UAE

ASIA PACIFIC:**JIAXING:**

Tel: +86 (0) 573 8357 0200
Email: asia_sales@luceco.com

No 1438, Jiachuang Road
Xiuzhou Industrial Park, Jiaxing
Zhejiang, China, P.C. 314031

MEXICO & LATIN AMERICA:

Tel: +52 (81) 5000 9437
Email: ventas@luceco.com

Luceco México S. de R.L. de C.V.
Batallón de San Patricio #109 Sur, Col.
Valle Oriente, San Pedro Garza García
N.L. México CP 66260 (Torre Avalanz,
Piso #20, Oficina 2009)

AFRICA:

Tel: +27 11 432 6779
Email: africa_sales@luceco.com

Unit 2, Cedarwood Office Park
Cnr. Western Service and
Mount Lebanon Road, Woodmead,
South Africa, 2144

TECHNICAL SUPPORT:

Tel: 03300 249 279
Email:
technical.support@bgelectrical.co.uk

Lines open Monday to Friday
8.30am to 5pm, with answer phone
service outside these hours.



Kingfisher
Lighting

www.bgelectrical.uk